

Connector - C-SCFI 1,5/6,3X0,8 - 3240052

Please be informed that the data shown in this PDF Document is generated from our Online Catalog. Please find the complete data in the user's documentation. Our General Terms of Use for Downloads are valid (<http://phoenixcontact.com/download>)



Slip-on sleeve, red, 0.5 ... 1.5 mm², 6.3 x 0.8

Your advantages

- ✓ Electrolytic tin plating
- ✓ Hard-soldered crimping zone for maximum pull-out forces
- ✓ Halogen-free
- ✓ 'EASY ENTRY' for easy and reliable conductor entry



Key Commercial Data

Packing unit	100 pc
GTIN	 4 046356 452700
GTIN	4046356452700

Technical data

Dimensions

Length (b)	21.5 mm
Width (a)	6.3 mm
Maximum stripping length	7 mm
Length of insulation sleeve (c)	10.5 mm
Inner dimension of the insulating collar (d)	4.1 mm
Material thickness (g)	0.4 mm

Ambient conditions

Ambient temperature (operation)	-20 °C ... 105 °C
---------------------------------	-------------------

General

Color	red
Stripping length	7 mm

Connector - C-SCFI 1,5/6,3X0,8 - 3240052

Technical data

General

Components	halogen-free
Flammability rating according to UL 94	V2
Material	Brass
Insulating material	PA
Coating	tin-plated

Standards and Regulations

Flammability rating according to UL 94	V2
--	----

Environmental Product Compliance

China RoHS	Environmentally friendly use period: unlimited = EFUP-e
	No hazardous substances above threshold values

Drawings

Connector - C-SCFI 1,5/6,3X0,8 - 3240052

Dimensional drawing

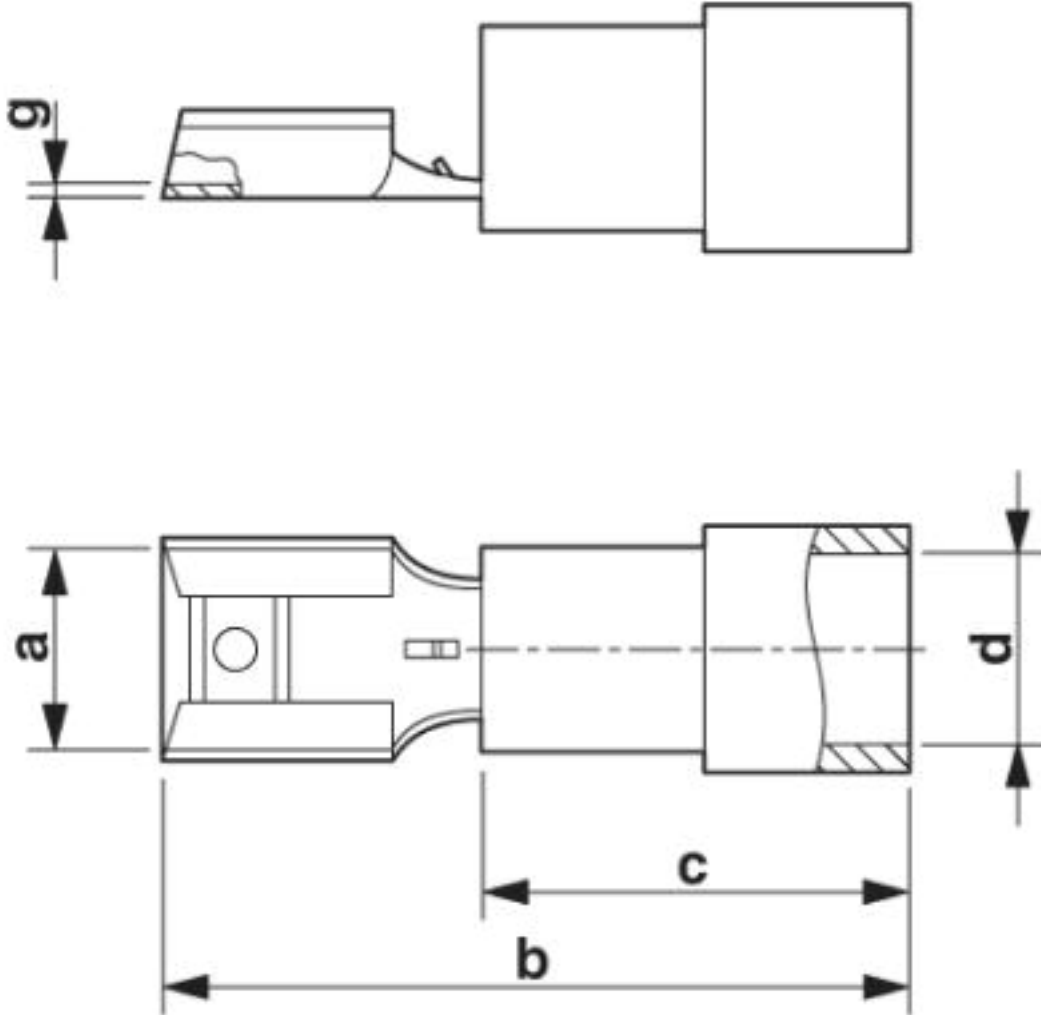

Approvals

Approvals

Approvals

EAC / EAC

Ex Approvals

Approval details

Connector - C-SCFI 1,5/6,3X0,8 - 3240052

Approvals

EAC		7500651.22.01.00246
-----	---	---------------------

EAC		EAC-Zulassung
-----	---	---------------

Phoenix Contact 2019 © - all rights reserved
<http://www.phoenixcontact.com>

PHOENIX CONTACT GmbH & Co. KG
Flachmarktstr. 8
32825 Blomberg
Germany
Tel. +49 5235 300
Fax +49 5235 3 41200
<http://www.phoenixcontact.com>