

SIDE VIEW

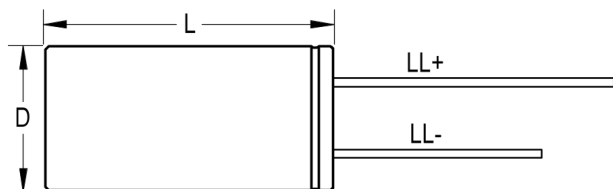

TERMINAL END VIEW

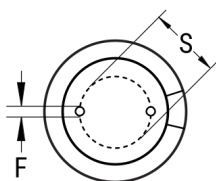

Click [here](#) for the 3D model.

### Dimensions

D	10mm +/-0.5mm
L	20mm +2.0mm
S	5mm +/-0.5mm
LL Negative	15mm MIN
LL Positive	20mm MIN
F	0.6mm NOM

### Packaging Specifications

Packaging	Bulk, Bag
Packaging Quantity	2400

### General Information

Series	ESL
Dielectric	Aluminum Electrolytic
Description	Single Ended Aluminum Electrolytic
RoHS	Yes
Lead	Wire Leads
AEC-Q200	No

### Specifications

Capacitance	270 uF
Capacitance Tolerance	20%
Voltage DC	63 VDC, 79 VDC (Surge)
Temperature Range	-40/+105°C
Rated Temperature	105°C
Life	10000 Hrs
Dissipation Factor	9% 120Hz 20C
Resistance	0.086 Ohms (100kHz 20C)
Ripple Current	1080 mAmps (100kHz 105C)
Leakage Current	170.1 uA (2min 20°C)
Impedance Ratio at -40C	4